

email it!

# Freedom Designs – Easy Conforming Back - Standard - (E2617)



Freedom Designs, Incorporated  
 2241 N Madera Road, Simi Valley, CA 93065  
 phone: 800-331-8551 fax: 888-582-1509  
 e: customerservice@freedomdesigns.com  
 www.freedomdesigns.com

Buyer: \_\_\_\_\_  
 Co./Account: \_\_\_\_\_  
 Location: \_\_\_\_\_  
 Contact #: \_\_\_\_\_  
 P.O. #: \_\_\_\_\_  
 Marked For: \_\_\_\_\_  
 Fax: \_\_\_\_\_  
 Email: \_\_\_\_\_

Quote     Order

## Wheelchair Specifications:

Model: \_\_\_\_\_  
 Width: \_\_\_\_\_



### 1. Choose Hardware

- 102-12000      4 J's and L's and 4 Glide Locks      \$ 969
- 102-17000      4 J's and L's and 2 Glide Locks with 2 Split Collars      \$ 969
- 102-20000      4 Easy Clamps      \$1125
- EZ CONF2      2 J's and L's and 2 Glide Locks and Hinges      \$ 969
- Heavy Duty Package (needed when frame is over 20" wide).      (Factory Quote)

### 2. Choose Modifications (may choose one or more)

- Mod-2QQ      Split Outer Wings (wings are cut in half as a standard)      \$226
- Mod-2SS      Laterals Upholstered Separately foam Center Panel      \$189
- Mod-2UU      Wings Molded Together in Front (only one angle of adjustment)      \$226
- Mod-2QPlateMate      PlateMate Universal Headrest Plate      \$ 46  
 (PlateMate needed when not using Freedom headrest)
- Mod-2S      Foam-in-Place (Choose  soft     medium)      \$245
- Mod-2Econo4      Hardware Upgrade with 4 Econo-Eze Hardware      \$164
- Mod-2Econo2      Hardware Upgrade with 2 Econo-Eze Hardware      \$ 55  
 (needed when using a hinge)

### 3. Chose Upholstery

- Black Lycra
- Black Dartex
- Black Reverse Dartex
- Other (Type and Color) \_\_\_\_\_

### 4. Choose Foam

Standard .5" 3# Foam w/.5" Soft Sunmate Overlay    OR     Custom/Omit Standard (see chart below)  
 Base Layer: \_\_\_\_\_ Middle Layer: \_\_\_\_\_ Top Layer: \_\_\_\_\_

Back Foam Chart					
<input type="checkbox"/> 3# Foam	\$ 44 per 1"	<input type="checkbox"/> Firm Sunmate	\$103 per 1"	<input type="checkbox"/> Pudgee	\$222 per 1"
<input type="checkbox"/> 4# Foam	\$ 44 per 1"	<input type="checkbox"/> X-Soft T-Foam	\$111 per 1"	<input type="checkbox"/> Waffle	\$264 per .5"
<input type="checkbox"/> 5# Foam	\$ 61 per 1"	<input type="checkbox"/> Soft T-Foam	\$111 per 1"	<input type="checkbox"/> Waffle (over 18x16)	\$529 per .5"
<input type="checkbox"/> Soft Sunmate	\$103 per 1"	<input type="checkbox"/> Medium T-Foam	\$111 per 1"	<input type="checkbox"/> Free Float	\$331 per .5"
<input type="checkbox"/> Med. Sunmate	\$103 per 1"	<input type="checkbox"/> Firm T-Foam	\$111 per 1"	<input type="checkbox"/> Free Float (over 18x16)	\$661 per .5"

# Freedom Designs – Easy Conforming Back - Standard

Buyer: \_\_\_\_\_  
 Co./Account: \_\_\_\_\_  
 Location: \_\_\_\_\_  
 Contact #: \_\_\_\_\_

P.O. #: \_\_\_\_\_  
 Marked For: \_\_\_\_\_  
 Fax: \_\_\_\_\_  
 Email: \_\_\_\_\_

## 5. Custom Sizing:

Width	Dimensions					
11/12	A=7	B=8	C=13	D=3	E=2	F=7
13/14	A=9.5	B=10.5	C=15	D=4	E=3	F=9
15/16	A=10.5	B=11.5	C=17	D=4	E=3	F=11
17/18	A=11	B=12.5	C=19	D=4	E=3	F=13
19/20	A=12	B=13.5	C=21	D=4	E=3.5	F=15
21/22	A=13	B=14.5	C=23	D=4	E=3.5	F=17
23/24	A=14	B=15.5	C=25	D=4	E=3.5	F=19
25/26	A=14	B=15.5	C=27	D=4	E=3.5	F=21

### Custom Size Chart

- A. Left \_\_\_\_\_  
 A. Right \_\_\_\_\_  
 B. Left \_\_\_\_\_  
 B. Right \_\_\_\_\_  
 C. \_\_\_\_\_  
 D. Left \_\_\_\_\_  
 D. Right \_\_\_\_\_  
 E. Left \_\_\_\_\_  
 E. Right \_\_\_\_\_  
 F. Standard  
 G. \* \_\_\_\_\_

\*G is for Mod-2-QQ  
 Split Outer Wing Only

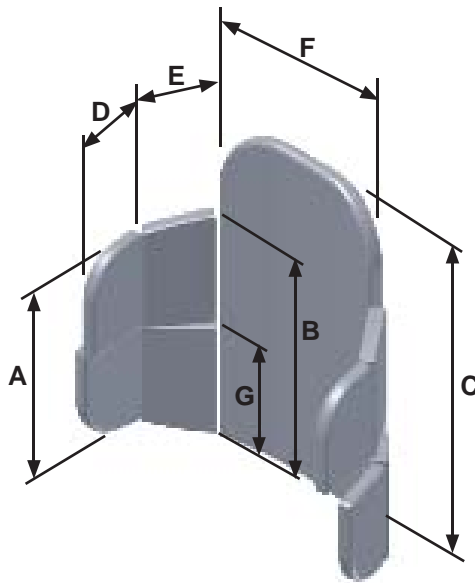

### Notes: