



# Freedom Designs, Inc.

## Easy Form



### Customer Information

Date: \_\_\_\_\_

Purchase Order #: \_\_\_\_\_

Dealer / Acct. #: \_\_\_\_\_

Ship to Street: \_\_\_\_\_

Ship to City: \_\_\_\_\_

Ship to State: \_\_\_\_\_

Ship to Zip Code: \_\_\_\_\_

Office / Mobile #: \_\_\_\_\_

Office Fax #: \_\_\_\_\_

E-mail Address: \_\_\_\_\_

Quote to:                      E-mail                      Fax

Buyer: \_\_\_\_\_

Marked For: \_\_\_\_\_

### Seating Specifications

A Back Height: \_\_\_\_\_

B Lateral Height: \_\_\_\_\_

C Lateral Width: \_\_\_\_\_

D Hip Width (rear): \_\_\_\_\_

E Set Up Seat Depth: \_\_\_\_\_

F Hip Width (front): \_\_\_\_\_

G "E" + 3" for Growth: \_\_\_\_\_

H Seat Width: \_\_\_\_\_

I Back Width: \_\_\_\_\_

**Important Note:** To ensure quote accuracy, seat and back width, depth and height dimensions must be provided. Seats and backs over 18" in width, depth or height are subject to oversize charges.

### Freedom Install Program

Purchase Order #: \_\_\_\_\_ of frame for install

**Freedom Install Program does not include power wheelchairs.**

### Wheelchair Specifications

Model: \_\_\_\_\_

Width: \_\_\_\_\_

Depth: \_\_\_\_\_

### Upholstery, Monograms, and Designs

Total system covered in one upholstery?

Yes or No

Contact Surface \_\_\_\_\_

Non-contact Surface \_\_\_\_\_

Monogram Name \_\_\_\_\_

Font - *Script* or Block - Thread Color \_\_\_\_\_

Design \_\_\_\_\_

### Finished Dimensions

Standard cut is Boltaron with foam rolled over edge.

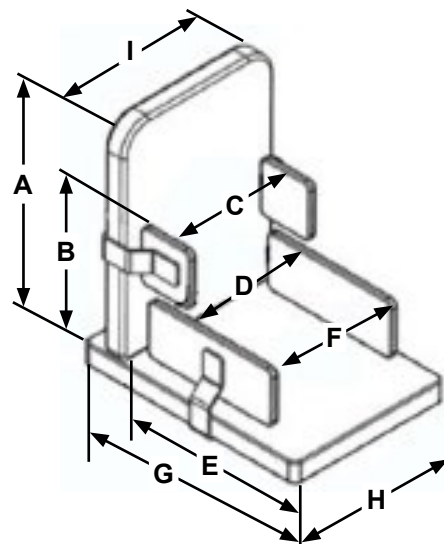



Our kids are our passion.™

# Freedom Designs, Inc

## Easy Form - Seat

M/F: \_\_\_\_\_

### Step 1. Choose Hardware for Planar / Flat Seat

**Note: Price includes 1/2" wood, 1-1/2" 4# foam and choice of upholstery.**

EE1	Two Knobs/Hinge (transport approved)	\$646
EE1-No Hardware	Two Knobs/Hinge - No Hardware	\$237
EZ Lite 1	Two EZ Lite/Hinge	\$471
EZ Lite 1-EXT	Two EZ Lite/Hinge (transport approved)	\$471
101-1000	Seat Insert	\$172
101-1000A	Seat Inserts w/T-Nuts	\$225
101-7000	J/L Quick Release (transport approved)	\$602
101-7500	Four Knobs (transport approved)	\$698
101-10000	Four EZ Lite	\$471
101-10000-EXT	Four EZ Lite Extended (transport approved)	\$471

### Step 2. Choose Modifications to Planar / Flat Seat

MOD-1K Anti-Thrust Seat Add \$210      MOD-1Y Contour Seat Add \$326

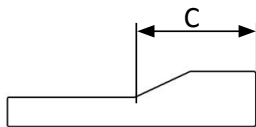

Height of anti-thrust shelf is 1"  
C = 3rd of set up seat up depth  
(see page1)

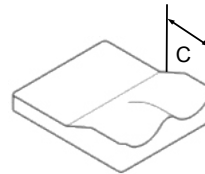

Leg trough depth is 1"  
Height of anti-thrust is 1"  
C = Half of set up seat depth  
(see page1)

MOD-1CR Asymmetrical - Long Right Add \$ 88

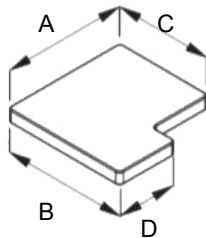

A \_\_\_\_\_  
B \_\_\_\_\_  
C \_\_\_\_\_  
D \_\_\_\_\_

MOD-1CL Asymmetrical-Long Left Add \$ 88

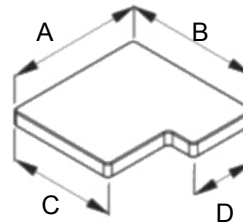

A \_\_\_\_\_  
B \_\_\_\_\_  
C \_\_\_\_\_  
D \_\_\_\_\_

MOD-1G	Cushion Separate From Wood	Add \$105
MOD-1I	Incontinent Liner	Add \$ 30
MOD-1L	Grid Seat Modification	Add \$333
MOD-1O	Notch For Back Posts	n/c
MOD-1P	Hook & Loop Strips	Add \$ 47/pr
MOD-1DD	Modular Contour Seat	Add \$432
MOD-1EE	Foam Full Width / Wood Between	Add \$164
MOD-1FF	Removable Incontinent Slip Cover	Add \$204
MOD-1GG	Track Mount Hardware - Long Dual Tracks	Add \$ 53/pr
MOD-1ROHO Seat	Freedom Seat ROHO Insert (see pg. 8 to specify order)	Add \$765



### Step 3. Choose Foam

1.5" Std 4# Foam Only

OR

Custom/Omit Standard (see chart below)

Base layer to be: \_\_\_\_\_ Middle layer to be: \_\_\_\_\_ Top layer to be: \_\_\_\_\_

Seat Foam Chart					
3# Foam	\$ 45 per 1"	Firm Sunmate	\$ 82 per 1"	Pudgee	\$209 per 1"
4# Foam	\$ 45 per 1"	X-Soft T-Foam	\$ 89 per 1"	Waffle	\$269 per .5"
5# Foam	\$ 47 per 1"	Soft T-Foam	\$ 89 per 1"	Waffle (over 18x16)	\$540 per .5"
Soft Sunmate	\$ 82 per 1"	Medium T-Foam	\$ 89 per 1"	Free Float	\$338 per .5"
Med. Sunmate	\$ 82 per 1"	Firm T-foam	\$ 89 per 1"	Free Float (over 18x16)	\$674 per .5"





Our kids are our passion.™

# Freedom Designs, Inc

## Easy Form - Back

M/F: \_\_\_\_\_

### Step 1. Choose Hardware for Planar / Flat Seat

Note: Price includes 1/2" wood, 1" 4# foam and choice of upholstery.

EE2	Two Knobs/Hinge (transport approved)	\$646
EE2-No Hardware	Two Knobs/Hinge - No Hardware	\$238
Easy Clamp2	Two Easy Clamps/Hinge (transport approved)	\$549
Fast Clamp2	Two Fast Clamps (transport approved)	\$443
Rotate 2	Two Rotate Clamps/Hinge (transport approved)	\$462
102-7500	Four Knobs (transport approved)	\$762
102-Easy Clamp	Four Easy Clamps (transport approved)	\$639
102-32000	Four Rotate Clamps (transport approved)	\$462

### Step 2. Choose Modifications to Planar / Flat Back

MOD-2I	Curved Wood	Add \$134	MOD-2H	I-MOD	Add \$128
MOD-2IA	Curved Foam	Add \$115	MOD-2J	T-MOD	Add \$128

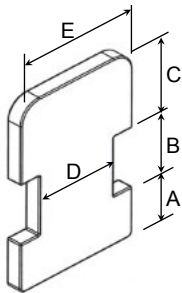

A \_\_\_\_\_  
B \_\_\_\_\_  
C \_\_\_\_\_  
D \_\_\_\_\_  
E \_\_\_\_\_

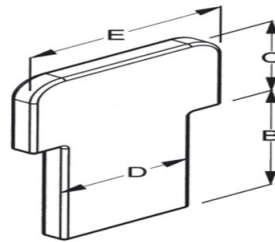

A \_\_\_\_\_  
B \_\_\_\_\_  
C \_\_\_\_\_  
D \_\_\_\_\_  
E \_\_\_\_\_

MOD-2L	Biangular	Add \$303	MOD-2DD	Adjust. Lumbar	Add \$299
--------	-----------	-----------	---------	----------------	-----------

Split at \_\_\_\_\_ from bottom

Start at \_\_\_\_\_ from bottom

<b>ROHO</b> MOD - 2K	Grid Back	Add \$333
MOD - 2ROHO Back	Freedom Back ROHO Insert (see pg.9 to specify order)	Add \$765
MOD - 2S	Foam-In-Place X Soft X Medium	Add \$259
MOD - 2S1	Foam-In-Place (chemicals only) X Soft X Medium	Add \$242
MOD - 2GG	Ergo Adjustable	Add \$422
MOD - 2JJ	Track Mount Hardware - Long Dual Tracks	Add \$ 58/pr

### Step 3. Choose Foam

1" Std 4# Foam Only **OR** Custom/Omit Standard (see chart below)

Base layer to be: \_\_\_\_\_ Middle layer to be: \_\_\_\_\_ Top layer to be: \_\_\_\_\_

Back Foam Chart					
3# Foam	\$ 45 per 1"	Firm Sunmate	\$105 per 1"	Pudgee	\$226 per 1"
4# Foam	\$ 45 per 1"	X-Soft T-Foam	\$113 per 1"	Waffle	\$269 per .5"
5# Foam	\$ 62 per 1"	Soft T-Foam	\$113 per 1"	Waffle (over 18x16)	\$540 per .5"
Soft Sunmate	\$105 per 1"	Medium T-Foam	\$113 per 1"	Free Float	\$338 per .5"
Med. Sunmate	\$105 per 1"	Firm T-foam	\$113 per 1"	Free Float (over 18x16)	\$674 per .5"





Our kids are our passion.™

# Freedom Designs, Inc

## Easy Form - Accessories

M/F: \_\_\_\_\_

### Medial Thigh - Abductor/Pommel

EE3B-2	Flip Down Abductor Wedge Or Oval	\$444
MOD-3E	Abductor Pad Only	\$170
MOD-3F	Extension Bracket/Abductor	\$ 28
EE3M	Anti-Thrust Pelvic Harness	\$247
	S M L XL or Hip Width _____	

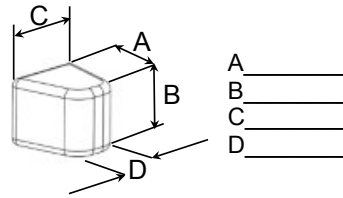

A \_\_\_\_\_  
B \_\_\_\_\_  
C \_\_\_\_\_  
D \_\_\_\_\_

#### Standard Sizes

Small	3L x 3H x 3-2 Taper
Medium	4L x 3H x 3-2 Taper
Large	5L x 4H x 4-2 Taper
X-Large	6L x 5H x 5-3 Taper

### Hip Guides

EE4A/B	Fixed - Flush/Offset	\$237/pair
EE4C	Quick Release Hip Guide	\$474/pair
MOD-4A	Contour for Anti-Thrust	\$ 90/pair
MOD-4D	Extension Bracket/Add	\$ 42/ea

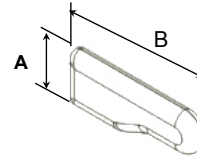

A = 4" high or \_\_\_\_\_"  
B = Set up seat depth or \_\_\_\_\_'

Flush 1" 2"  
Mounted at: Hip or Knee

### Trunk Supports

EE5A/B	Fixed - Flush/Offset	\$237/pair
EE5E	Lift Swing Away	\$474/pair
EE5I	Tracks	\$ 52/pair
EE5J	Fixed Swing Away Summer Winter	\$402/pair
EE5K	Lever Swing Away	\$633/pair
EE5P	Lever Swing Away	\$532/pair
EE5Q	Lever Swing Away Summer Winter	\$669/pair
EE5W	<b>NEW</b> Push Button S/A	\$474/pair
MOD-5F	Protective Covering Over Hardware	\$ 54/pair

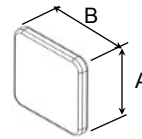

A \_\_\_\_\_  
B \_\_\_\_\_  
4L x 3H  
5L x 4H  
6L x 5H

#### Tracks

3"	Single
5"	Single
7"	Single
9"	Single
11"	Single
9"	Double
11"	Double

#### Trunk Supports

Std. (1" thick) Flat OR Thin (.5" thick) Curved  
Flush 1" 2"

### Headrest Hardware

7700	Vertical and Horizontal Adjustment - Fixed Removable	\$144
7702	Flip Down - Not Removable	\$282
7708	Rock and Roll Removable	\$393
7709	Rock and Roll Flip Down - Not Removable	\$402
7711	<b>NEW</b> Adjust-Exe Multi-Position Removable	\$230
7733	Adaptaplate - Universal Plate - Freedom Designs and Other Manufactures	\$ 63
77Platemate	Universal Plate for all Headrests - Whitmyer, Otto Bock, Stealth	\$ 43

### Headrest Pads

7755	Extension Pad	W _____ x H _____	\$124
7753	3-Pieced Hinged	Small 4W x 4H Medium 4W x 5H Large 5W x 5H	\$314
7756	Chubbie	Small 10W x 4H Medium 12W x 5H Large 13.5W x 4.5H	\$188
7757	Low Profile	Small 8.5W x 3.5H Medium 9W x 4H Large 3W x 4H	\$149
7760	Skinny	Small 8W x 4.5H Medium 10W x 4.5H Large 12W x 4.5H	\$188

### Belts

SB-3331	Squeeze Release, 2 pt., Center Pull	XS S M L XL	\$ 68
SB-3332	Metal Push Button, 2 pt., Center Pull	XS S M L XL	\$ 90
SB-3334	EZ-Release, 2 pt., Center Pull	XS S M L XL	\$ 90
SB-3362	EZ-Release, 4 pt., Center Pull	XS S M L XL	\$110



# Freedom Designs, Inc

## Easy Form - Trays and Foot Boxes

M/F: \_\_\_\_\_

Our kids are our passion.™

### Ankle Supports

EE9B-D	High Top, Buckle, Dynamic	XS	S	M	L	\$111
EE9F-D	3 Point High Tops	XS	S	M	L	\$169
	Ankle Circumference=	(5 1/2"-8 1/2")	(7 1/2"-10 1/2")	(9 1/2"-12 1/2")	(11 1/2"-14 1/2")	

### Shoe Holders

EE9	Shoe Holders - Velcro	S	SM	M	ML	L	XL	\$166
EE9C	Shoe Holders - Buckle	S	SM	M	ML	L	XL	\$166
EE9G	Shoe Holders - Combo	S	SM	M	ML	L	XL	\$166
	Shoe Sizing=	(5")	(5.75")	(6.5")	(7.25")	(8")	(10")	
MOD-9G	Foot Plate Pads - Pair	W _____ x D _____						\$161

### Foot Boxes

08-10000	Leg Cradles	\$603	08-11000	Foot Box	\$515
----------	-------------	-------	----------	----------	-------

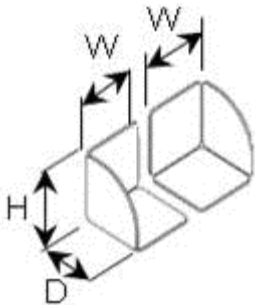

Hanger Mount

Footplate/Footboard Mount

W—Fits between hangers

D \_\_\_\_\_

H \_\_\_\_\_

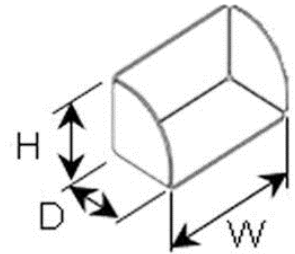

### Tray

What is the width of the frame \_\_\_\_\_?

08-1000	Lexan Tray w/Velcro	\$197
08-2000	Lexan Tray w/Channel Brackets & Ribs	\$271
08-6000	Lexan Tray w/Adjustable Hardware & Ribs	\$219
08-8000	Lexan Tray Nor Hardware	\$159
08-12000	EZ-Lite Tray	\$170
08-13000	EZ-Lite Tray w/Ribs	\$183
08-16000	1/4: Laxan Tray w/Hook & Loop	\$106

Tray Sizes		
Size	Description	
X-Small	10" - 11" wide chair, Tray dimensions—21"wide x 18" deep, body cut out— 10" w x 7" deep	
Small	12" - 13" wide chair, Tray dimensions—21"wide x 18" deep, body cut out— 12" w x 7" deep	
Medium	14" - 15" wide chair, Tray dimensions—24"wide x 22" deep, body cut out— 14" w x 9" deep	
Large	16" - 17" wide chair, Tray dimensions—26"wide x 24" deep, body cut out— 16" w x 10" deep	
X-Large	18" - 19" wide chair, Tray dimensions—28"wide x 14" deep, body cut out— 18" w x 10" deep	

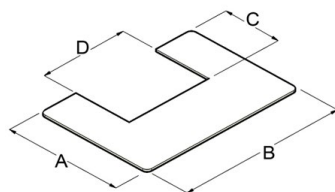

A \_\_\_\_\_  
 B \_\_\_\_\_  
 C \_\_\_\_\_  
 D \_\_\_\_\_





Our kids are our passion.™

# Freedom Designs, Inc

## Easy Form - Anterior Chest Supports

M/F: \_\_\_\_\_

### Anterior Chest Supports

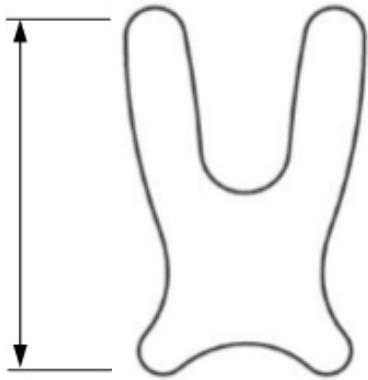

**EE6R \$164**

**MOD-6A-1 \$53/pr.**  
Strap Riser

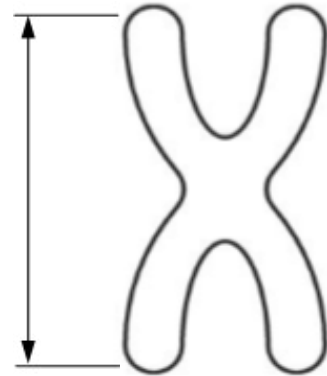

**EE6S \$164**

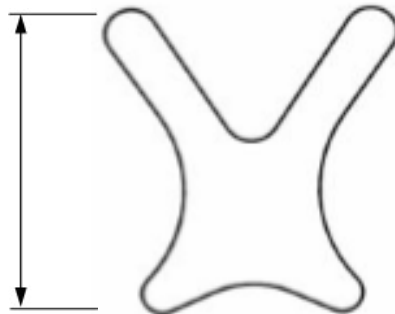

**EE6U \$164**

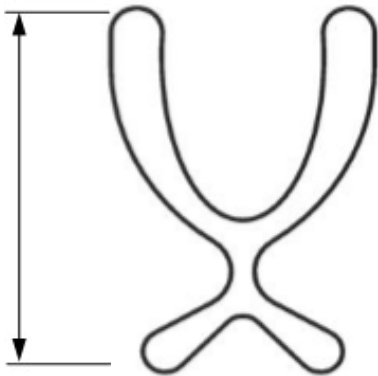

**EE6V \$164**

Size
XX Small
XSmall
Small
Medium
Large
XLarge

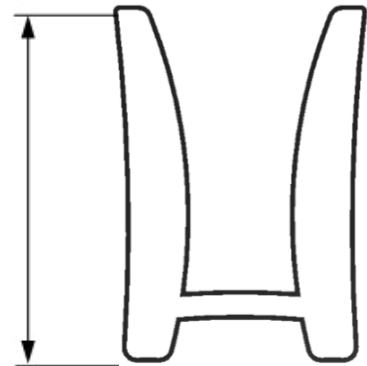

**EE6X \$165**

Length of Pad						
Chest Support	XXS	XS	S	M	L	XL
EE6R	12"	12.5"	17.25"	18.75"	20.25"	21.5"
EE6S	12.5"	14.25"	15.5"	17"	18.25"	20"
EE6U	N/A	10"	11"	11.75"	12.5"	14.5"
EE6V	N/A	10"	14"	16.25"	20"	22"
EE6X	N/A	N/A	9.25"	11.25"	13.5"	N/A





Our kids are our passion.™

# Freedom Designs, Inc

## Easy Form - Select Anterior Chest Supports

M/F: \_\_\_\_\_

### Freedom Select Anterior Trunk Supports

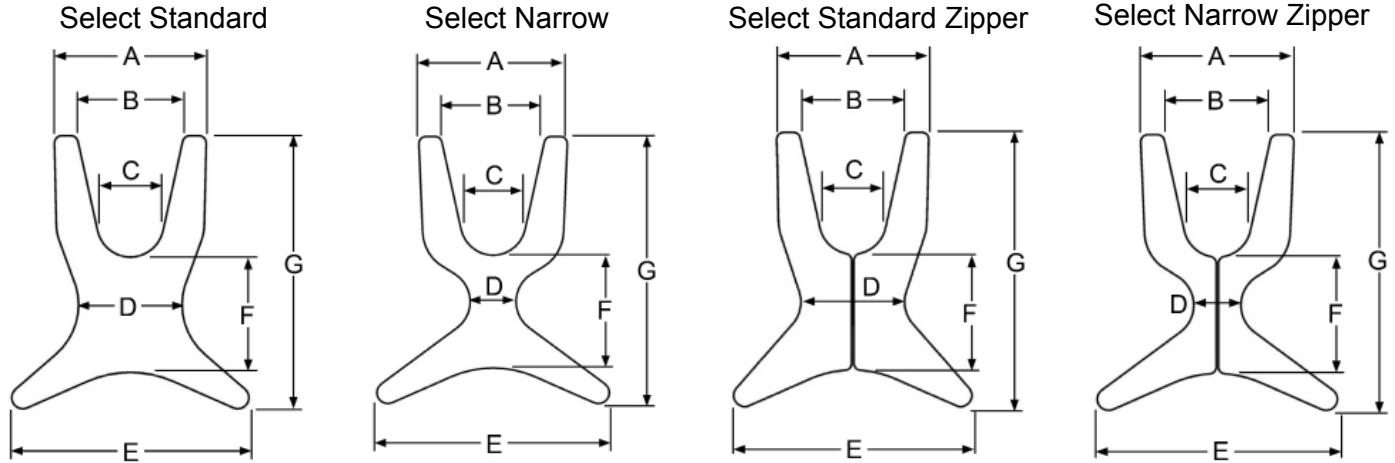

Freedom Select Support										
Order	Part Number	Freedom Select Support	Dimensions							Price
			A	B	C	D	E	F	G	
	SFDI-6SNZ-S	Select Standard Small	7.5	4.5	3.25	6	11	5.25	13.75	\$133
	SFDI-6SNZ-M	Select Standard Medium	9.5	6.5	4	6.5	14.75	7.25	17	\$133
	SFDI-6SNZ-L	Select Standard Large	10.5	7.5	4.5	6.75	18	9	19.75	\$143
	SFDI-6SNZ-XL	Select Standard Extra Large	10.5	7.5	4.5	7.75	21.75	10	22	\$143
	SFDI-6NNZ-M	Select Narrow Medium	9.5	6.5	4	3	14.75	7.25	17	\$133
	SFDI-6NNZ-L	Select Narrow Large	10.5	7.5	4.5	3.5	18	8	19.75	\$138
	SFDI-6NNZ-XL	Select Narrow Extra Large	10.5	7.5	4.5	4.25	21.75	10	22	\$143
	SFDI-6SZ-S	Select Standard Zipper Small	7.5	4.5	3.25	6	11	5.25	13.75	\$138
	SFDI-6SZ-M	Select Standard Zipper Medium	9.5	6.5	4	6.5	14.75	7.25	17	\$138
	SFDI-6SZ-L	Select Standard Zipper Large	10.5	7.5	4.5	6.75	18	9	19.75	\$143
	SFDI-6SZ-XL	Select Standard Zipper Extra Large	10.5	7.5	4.5	7.75	21.75	10	22	\$148
	SFDI-6NZ-M	Select Narrow Zipper Medium	9.5	6.5	4	3	14.75	7.25	17	\$138
	SFDI-6NZ-L	Select Narrow Zipper Large	10.5	7.5	4.5	3.5	18	8	19.75	\$143
	SFDI-6NZ-XL	Select Narrow Zipper Extra Large	10.5	7.5	4.5	4.25	21.75	10	22	\$148





Our kids are our passion.™



PO# \_\_\_\_\_

Marked for: \_\_\_\_\_

- Cell Size
- 1"
- 2"
- 3"
- 4"
- Deleted Cells Base Intact
- X
- Cut Out Cells & Base
- C
- Valve Hose Location Corner & Cell Height
- V1
- V2
- V3
- V4
- Select Seat Choice
- Standard
- Asymmetrical Left
- Asymmetrical Right
- Other
- 

## MOD-1ROHO SEAT

## Freedom Seat ROHO Insert

**\$765.00**

Note: Retail pricing includes any combination of specification option.

### FRONT OF INSERT COLUMNS

INCHES	CELLS	3	4.75	6.5	8	9.75	11.5	13.25	15	16.5	18.25	20	21.75
		1	2	3	4	5	6	7	8	9	10	11	12
		A	B	C	D	E	F	G	H	I	J	K	L
3	1	<input type="checkbox"/>	<input type="checkbox"/>	<input type="checkbox"/>	<input type="checkbox"/>	<input type="checkbox"/>	<input type="checkbox"/>	<input type="checkbox"/>	<input type="checkbox"/>	<input type="checkbox"/>	<input type="checkbox"/>	<input type="checkbox"/>	<input type="checkbox"/>
4.75	2	<input type="checkbox"/>	<input type="checkbox"/>	<input type="checkbox"/>	<input type="checkbox"/>	<input type="checkbox"/>	<input type="checkbox"/>	<input type="checkbox"/>	<input type="checkbox"/>	<input type="checkbox"/>	<input type="checkbox"/>	<input type="checkbox"/>	<input type="checkbox"/>
6.5	3	<input type="checkbox"/>	<input type="checkbox"/>	<input type="checkbox"/>	<input type="checkbox"/>	<input type="checkbox"/>	<input type="checkbox"/>	<input type="checkbox"/>	<input type="checkbox"/>	<input type="checkbox"/>	<input type="checkbox"/>	<input type="checkbox"/>	<input type="checkbox"/>
8	4	<input type="checkbox"/>	<input type="checkbox"/>	<input type="checkbox"/>	<input type="checkbox"/>	<input type="checkbox"/>	<input type="checkbox"/>	<input type="checkbox"/>	<input type="checkbox"/>	<input type="checkbox"/>	<input type="checkbox"/>	<input type="checkbox"/>	<input type="checkbox"/>
9.75	5	<input type="checkbox"/>	<input type="checkbox"/>	<input type="checkbox"/>	<input type="checkbox"/>	<input type="checkbox"/>	<input type="checkbox"/>	<input type="checkbox"/>	<input type="checkbox"/>	<input type="checkbox"/>	<input type="checkbox"/>	<input type="checkbox"/>	<input type="checkbox"/>
11.5	6	<input type="checkbox"/>	<input type="checkbox"/>	<input type="checkbox"/>	<input type="checkbox"/>	<input type="checkbox"/>	<input type="checkbox"/>	<input type="checkbox"/>	<input type="checkbox"/>	<input type="checkbox"/>	<input type="checkbox"/>	<input type="checkbox"/>	<input type="checkbox"/>
13.25	7	<input type="checkbox"/>	<input type="checkbox"/>	<input type="checkbox"/>	<input type="checkbox"/>	<input type="checkbox"/>	<input type="checkbox"/>	<input type="checkbox"/>	<input type="checkbox"/>	<input type="checkbox"/>	<input type="checkbox"/>	<input type="checkbox"/>	<input type="checkbox"/>
15	8	<input type="checkbox"/>	<input type="checkbox"/>	<input type="checkbox"/>	<input type="checkbox"/>	<input type="checkbox"/>	<input type="checkbox"/>	<input type="checkbox"/>	<input type="checkbox"/>	<input type="checkbox"/>	<input type="checkbox"/>	<input type="checkbox"/>	<input type="checkbox"/>
16.5	9	<input type="checkbox"/>	<input type="checkbox"/>	<input type="checkbox"/>	<input type="checkbox"/>	<input type="checkbox"/>	<input type="checkbox"/>	<input type="checkbox"/>	<input type="checkbox"/>	<input type="checkbox"/>	<input type="checkbox"/>	<input type="checkbox"/>	<input type="checkbox"/>
18.25	10	<input type="checkbox"/>	<input type="checkbox"/>	<input type="checkbox"/>	<input type="checkbox"/>	<input type="checkbox"/>	<input type="checkbox"/>	<input type="checkbox"/>	<input type="checkbox"/>	<input type="checkbox"/>	<input type="checkbox"/>	<input type="checkbox"/>	<input type="checkbox"/>
20	11	<input type="checkbox"/>	<input type="checkbox"/>	<input type="checkbox"/>	<input type="checkbox"/>	<input type="checkbox"/>	<input type="checkbox"/>	<input type="checkbox"/>	<input type="checkbox"/>	<input type="checkbox"/>	<input type="checkbox"/>	<input type="checkbox"/>	<input type="checkbox"/>
21.75	12	<input type="checkbox"/>	<input type="checkbox"/>	<input type="checkbox"/>	<input type="checkbox"/>	<input type="checkbox"/>	<input type="checkbox"/>	<input type="checkbox"/>	<input type="checkbox"/>	<input type="checkbox"/>	<input type="checkbox"/>	<input type="checkbox"/>	<input type="checkbox"/>

INCHES ARE FROM BASE EDGE TO EDGE OF INSERT

1. Start diagram at cell 1A which represents front left of cushion from client's seated position.
2. Specify "Cell Height" (1", 2", 3" or 4") by placing a number in each cell box.
3. Specify request to "Delete Cells with Base Intact" by typing an "X" in those cell boxes.
4. Specify request to "Cut Out Cells & Base" by typing a "C" in those cell boxes.
5. Specify "Valve Hose Location Corner & Cell Height" by typing "V1", "V2", "V3" or "V4" in that corner box.

Note: For multiple valve or custom valve locations and custom air chamber divisions call Freedom Designs Customer Service for assistance at 800-331-8551

**PLEASE ALLOW 3-4 WEEKS FOR DELIVERY**







Our kids are our passion.™



PO# \_\_\_\_\_

Marked for: \_\_\_\_\_

## MOD-2ROHO BACK

## Freedom Back ROHO Insert

**\$765.00**

Note: Retail pricing includes any combination of specification option.

### TOP OF INSERT

#### COLUMNS

INCHES	→ 3	4.75	6.5	8	9.75	11.5	13.25	15	16.5	18.25	20	21.75
--------	-----	------	-----	---	------	------	-------	----	------	-------	----	-------

CELLS	→ 1	2	3	4	5	6	7	8	9	10	11	12
-------	-----	---	---	---	---	---	---	---	---	----	----	----

	A	B	C	D	E	F	G	H	I	J	K	L
--	---	---	---	---	---	---	---	---	---	---	---	---

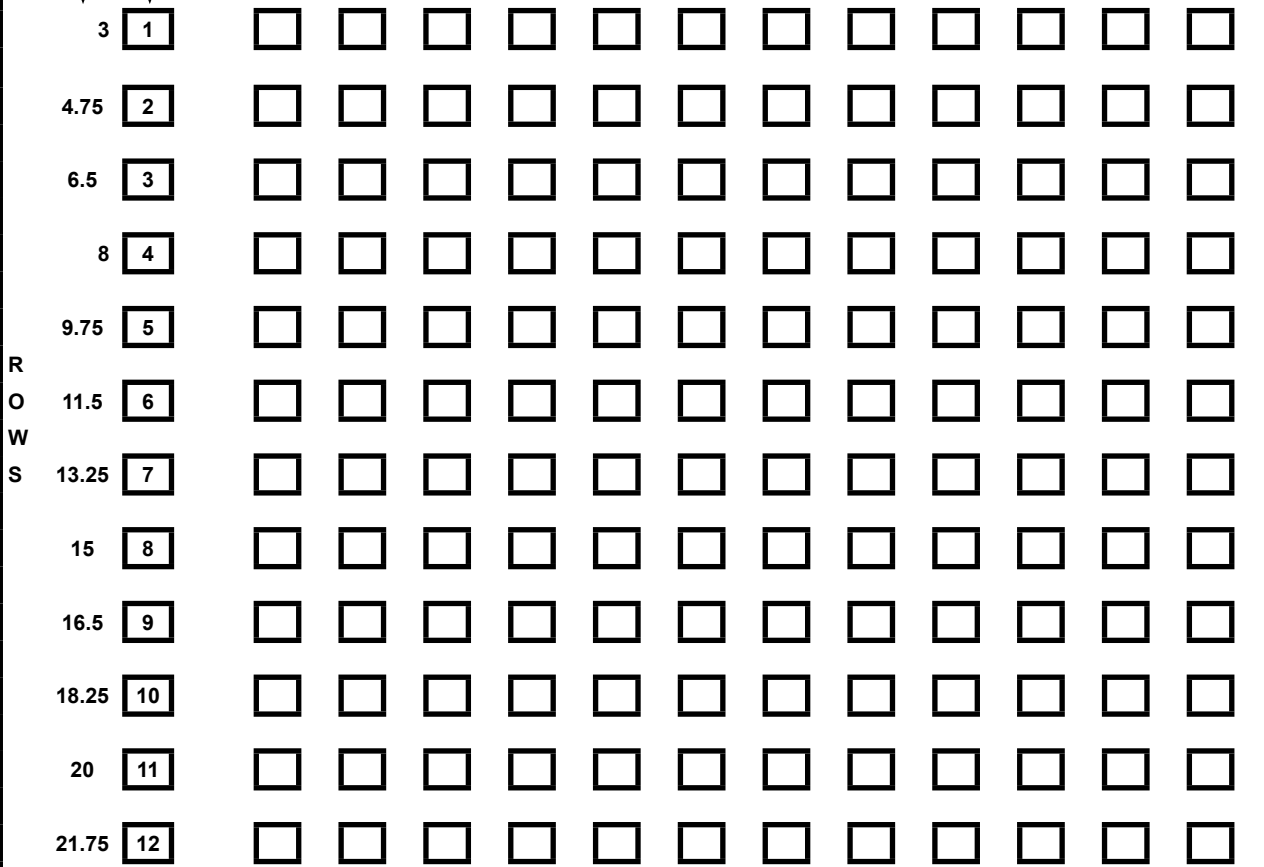

INCHES ARE FROM BASE EDGE TO EDGE OF INSERT

1. Start diagram at cell 1A which represents top right of back from client's seated position.
  2. Specify "Cell Height" (1", 2", or 3") by placing a number in each cell box.
  3. Specify request to "Deleted Cells with Base Intact" by typing an "X" in those cell boxes.
  4. Specify request to "Cut Out Cells & Base" by typing a "C" in those cell boxes.
  5. Specify "Valve Hose Location Corner & Cell Height" by typing "V1", "V2", or "V3" in that corner box.
- Note: For multiple valve or custom valve locations and custom air chamber divisions call Freedom Designs Customer Service for assistance at 800-331-8551

**PLEASE ALLOW 3-4 WEEKS FOR DELIVERY**

Cell Size

Deleted Cells Base Intact

Cut Out Cells & Base

Valve Hose Location Corner & Cell Height

Select Back Choice

Standard

"I" Back

"T" Back

