



Yes, you can.®

PRO-CG™ Adult Manual Wheelchair



Thank you for using Freedom Designs / Invacare eForms

Invacare is pleased to offer you an upgraded solution to your ordering process. Our enhanced order forms allow you to fill out a form electronically, print and fax the form, save and email* it to Customer Service, or maintain the business practices that work for you today. The format has been revised to reveal a cleaner look with electronic selection and input functions.

For additional information please visit www.freedomdesigns.com



Adobe Acrobat Reader DC

* Interactive functions of our new forms work best with the latest version of Adobe Acrobat Reader DC visit <https://get.adobe.com/reader/> to download and install on your PC or Mac or visit Google Play/ iTunes to download the Adobe Acrobat Reader DC app for your device.

Save

Adobe Acrobat Reader DC allows you to save this form with your content - to complete later or use as a starting point for your next form.

Please note that content must be added and saved in Acrobat - saving content from completed forms in the browser may not be possible.

Submit

Adobe Acrobat Reader DC allows you to submit this form electronically via your email client.

Simply click the submit button below and step through the simple process.

Print

If you do not have access to Adobe Acrobat Reader DC simply print this form and complete it by hand and fax it to our Customer Service Department at:

800-331-8551



Account Information

Request Type: Quote Order

Date: _____

Account #: _____

Company: _____

SHIP TO
Name: _____

Address: _____

City: _____ State: _____ Zip: _____

Country: _____

Purchase Order #: _____

CONTACT
Name: _____

Back Up Contact: _____

Phone: _____

Email: _____

Comments: _____

MF: Please do not provide with a customer name

Base Options

A seating system must be purchased separately. No seating system is provided with the PRO-CG frame. No seat or back upholstery is available as an option.

TRANSPORT OPTIONAL

PRO-30310 PRO-CG Adult Rigid\$3,215 (E1161)
 Transportation Option selected separately below. Includes Freedom Future Fit Program

PRO-99998 Transport Brackets.....\$323
 Must be installed by Freedom Designs manufacturing. Freedom's combination of customized seating and wheelchair frames are WC19 crash test approved in accordance with RESNA WC-4: 2012 Section 19, Annexes A, B, C & E as well as ISO 7176-19 (2008) Annexes A, C & D. Most Freedom seating, hardware, and positioning accessories have been WC20 tested and approved for transit.

TRANSPORT INCLUDED

PRO-30311 PRO-CG Adult Rigid.....\$3,548 (E1161)
 Includes Freedom Future Fit Program

Frame Dimensions

PRO-30240 16" Base Width

Specify Seat Width Setting

- PRO-14W 14" n/c
- PRO-15W 15" n/c
- PRO-16W 16" n/c
Seat frame adjusts 14" to 16" wide in 1" increments.

Specify Seat Depth Setting

- PRO-30506 14" n/c
- PRO-30521 15" n/c
- PRO-30522 16" n/c
- PRO-30523 17" n/c
- PRO-30524 18" n/c
- PRO-30527 19" n/c
2" extension required
- PRO-30528 20" \$592 (E2203)
2" extension required
- PRO-30529 21" \$592 (E2203)
4" extension required
- PRO-30535 22" \$1,065 (E2204)
4" extension required

PRO-30260 18" Base Width

Specify Seat Width Setting

- PRO-16W 16" n/c
- PRO-17W 17" n/c
- PRO-18W 18" n/c
Seat frame adjusts 16" to 18" wide in 1" increments.

Specify Seat Depth Setting

- PRO-30522 16" n/c
- PRO-30523 17" n/c
- PRO-30524 18" n/c
- PRO-30527 19" n/c
- PRO-30528 20" \$592 (E2203)
- PRO-30529 21" \$592 (E2203)
2" extension required
- PRO-30536 22" \$1,065 (E2204)
4" extension required
- PRO-30537 22" \$1,065 (E2204)
4" extension required



Yes, you can.®



PRO-CG™ Adult Manual Wheelchair

PRO-30261 20" Base Width

Specify Seat Width Setting

- PRO-18W 18" n/c
 - PRO-19W 19" n/c
 - PRO-20W 20" \$538 (E2201)
- Seat frame adjusts 18" to 20" wide in 1" increments.

Specify Seat Depth Setting

- PRO-30524 18" n/c
- PRO-30527 19" \$590
- PRO-30528 20" \$592 (E2203)
- PRO-30529 21" \$592 (E2203)
- PRO-30535 22" \$1,065 (E2204)
- PRO-30536 23" \$1,065 (E2204)
2" extension required
- PRO-30537 24" \$1,065 (E2204)
2" extension required
- PRO-30538 25" \$1,065 (E2204)
4" extension required
- PRO-30539 26" \$1,065 (E2204)
4" extension required

SEAT RAIL EXTENSIONS

- PRO-30525 2" Extension - Pair.....\$45 (K0108)
- PRO-30531 4" Extension - Pair\$45 (K0108)

Specify Back Post Location (if other than specified above) _____"

Seat Rail Options

LEAF - LOWER EXTREMITY ACCOMMODATION FRAME

Not available with ALL Contracture & 3D Dynamic footrest systems.

- PRO-30324 LEAF Seat Frame- Pair \$834 (K0108)

Front frame angle adjusts 22° from midline for abduction, adduction, and windswept lower extremity positioning. Seat frame(s) can be individually repositioned for up to a 2" leg length discrepancy.

SRO - SEAT RAIL ONLY

- PRO-30325 SRO Seat Frame- Pair..... \$350 (K0108)
- SRO is manufactured without standard footrest hanger attachments.

Vent Options

- PRO-30335 Vent Tray Base W/ Tray..... \$634 (E1029)

Extended wheelchair base including vent tray. For LP10 style vent, base must be 16" or greater. Tray measures full width of the base frame and 12" deep

- 11-1100 Back Post Mounted Vent Bracket..... \$633 (E1029)
- For LTV vents ONLY. Does NOT include dovetail bracket. Weight limit 15 lbs.

Auxillary Device Mounts

- 11-3100 O2 Holder - Aluminum w/ QR Hdwe....\$631 (K0108)

- 11-4000 IV Pole w/ Mounting Hardware.....\$311 (K0108)

Tilt Activations

- PRO-30272 Dual Lever Hand Activated Tiltn/c

- PRO-30273 Foot Activated Tilt.....n/c
- Not available with vent tray.



Frame Colors (Includes Seat Rail, Caster Housing, and Hangers)

Sugar Cookie..... n/c	Candy Violet..... n/c	Electric Blue..... n/c	Fiery Red..... n/c
Neon Yellow..... n/c	Candy Raspberry n/c	Galaxy Blue..... n/c	Twilight..... n/c
Yellow..... n/c	Extreme Green..... n/c	Passion Purple..... n/c	Stormy Gray..... n/c
Bright Pink..... n/c	Sparkle Green..... n/c	Octane Orange..... n/c	Black..... n/c
Pink Parfait..... n/c	Mystic Teal..... n/c	Red Sunset..... n/c	Color to be Determined..... n/c
Sugar Plum..... n/c	Pacific Blue..... n/c	Really Red..... n/c	

Base Colors

PRO-BBASE Black Base.....n/c	PRO-CACCENT Accent Base Color.....\$150
PRO-CBASE Matching Base and Frame Color.....\$100	

Back Posts

BACK POST OPTIONS

PRO-30545 Fold-Down Back Posts.....n/c	PRO-30564 Reduced Shear Recline Back with Angle-Adjustable Stroller Handle Extension.....\$1,712
--	--

PRO-30562 Reduced Shear Recline Back.....\$1,500 (E1226)

PRO-30542 Dynamic Rocker Back - Seating Dynamics.....\$2,200 (E2398)

Angle adjustable from 72° to 108° in 6° increments. Can be locked-out when needed.

Includes a set of 4 elastomers in different durometers to allow spring adjustment in the field.

Recline range is 65° from 97° to 162°. Pivot point is 2.5" above the seat rail. Solid Back Insert installation requires 4-points of attachment hardware. Seat-to-Back hinges are not compatible with any Super Reclining Reduced Shear Back.

PUSH HANDLE OPTIONS

PRO-30518 90° Bend Back Post Tubes.....n/c	PRO-30544 Straight Back Post Tubes.....n/c
	Requires selection of Push Button Angle Adjustable Stroller Handle (PRO-30571 or PRO-30576). Not available with Reduced Shear Recline Back.

PUSH HANDLE HEIGHT

PRO-30515 Short - 20" High.....n/c	PRO-30516 Tall - 26" High.....n/c
PRO-30514 Medium - 23" High.....n/c	

Push Handle Extension Options



All push handle extensions except PRO-30561 add approximately 6.5" to push handle height. All push handle extensions except Individual include a black neoprene wrap around pad.

PRO-30561 Push Handle Extension - Width Adjustable..n/c
Not available with Straight Back Posts. Not available with Recline.

PRO-30571 Push Button, Angle-Adjustable Stroller Handle Extension\$121
Available on wheelchair frames 15W & smaller only. Plastic hinge up to 200° range of adjustment. PRO-30571 or PRO-30576 required with Straight Back Post Tubes (PRO-30544)

PRO-30517 Individual Stroller Handle Extensions Removable - Pair\$119
Not available with Straight Back Posts. Not available with Recline.

PRO-30590 Stroller Handle Extension - Width Adjustable, Removable\$103
Not available with Straight Back Posts. Not available with Recline.

PRO-30576 Heavy Duty Push Button, Angle-Adjustable Stroller Handle Extension\$193
Available on any size frame. Metal hinge up to 180° range of adjustment. PRO-30571 or PRO-30576 required with Straight Back Post Tubes (PRO-30544)

Footrests

Footrest / Extension Lengths

Extension/Hanger	75° Pop	75° Lch	90° Pop	90 °Lch	ELR (90°)
Hanger Only	6"-8"	5.5"-8.5"	4"-8"	4"-8"	6"-12"
High Mount	N/A	N/A	1.5"-3"	N/A	N/A
4.5" H D Ext.	9"-12"	9.5"-12.5"	9"-12"	9"-12"	13"-15"
6.5" H D Ext.	9"-15"	9.5"-15.5"	9"-15"	9"-15"	13"-17"
4" Adjustable	10"-13"	9.5"-12.5"	11"-13"	10"-13"	13"-15"
6" Adjustable	12"-15"	10.5"-14.5"	13"-15"	12"-15"	13"-18"
8" Adjustable	14"-17"	12.5"-16.5"	N/A	N/A	14"-20"
10" Adjustable	16"-19"	14.5"-18.5"	N/A	N/A	16"-22"



MAPS Footrest / Extension Lengths

Extension/Hanger	75° Pop	75° Lch	90° Pop	90 °Lch	ELR (90°)
Hanger Only	5.5"-7.5"	5"-8"	5.5"-7.5"	4.5"-7.5"	4.5"- 8.5" & 11.5"
High Mount	N/A	N/A	N/A	N/A	N/A
4.5" H D Ext.	8.5"-11.5"	9"-12"	8.5"-11.5"	8.5"-11.5"	12.5"-14.5"
6.5" H D Ext.	8.5"-13.5"	9"-14"	8.5"-13.5"	8.5"-13.5"	12.5"-16.5"
4" Adjustable	8.5"-11.5"	9"-12"	9.5"-11.5"	8.5"-11.5"	12.5"-14.5"
6" Adjustable	10.5"-13.5"	10"-14"	11.5"-13.5"	8.5"-13.5"	12.5"-17.5"
8" Adjustable	12.5"-15.5"	12"-16"	N/A	N/A	13.5"-19.5"
10" Adjustable	14.5"-17.5"	14"-18"	N/A	N/A	15.5"-21.5"

Length is measured from top of footrest plate to top of seat rail. Without extensions bottom hanger hole not accessible for hardware. Heavy duty extensions do not telescope adjust. Footrests adjust vertically in length on heavy duty extension tubes.

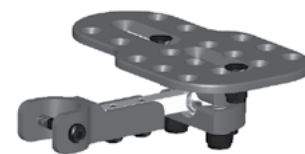



PRO-CG™ Adult Manual Wheelchair

HANGERS

- PRO-30280 75° Pop-Up Swing Away Hangers.....n/c
- PRO-30281 90° Pop-Up Swing Away Hangers.....n/c
Not available with 8" or 10" Telescoping Extensions.
- PRO-30279 90° Pop-Up Swing Away Elevating Legrests (ELRs).....\$318 (E099)
Not available with all Telescoping extensions.

- PRO-30282 75° Latch Style Swing Away Hangers.....n/c
- PRO-30283 90° Latch Style Swing Away Hangers.....n/c
Not available with 8" or 10" Telescoping Extensions.
- PRO-33000 Omit Legrest Hangers & Footrests.....n/c

FOOTPLATES & FOOTBOARDS

- PRO-36033 Aluminum Angle Adj. Flip-up Footplates\$205 (K0040)
Does not include Heel Loops, select below.
- PRO-17070 Composite Flip-Upn/c

- PRO-36029 Aluminum Angle Adjustable Footboard Removable\$205 (K0040)
- PRO-36404 Omit Footrest Platesn/c

FOOTPLATE OPTIONS

- PRO-36040 MAPS (Multi Axis Positioning System)\$350
Requires selection of Aluminum Angle Adjustable Footplates. Not compatible with Composite footplates or Aluminum Footboard. Not compatible with Seating Dynamics hangers.

- PRO-36022 Heel Loops.....\$49 (E0951)
- PRO-36024 Calf Strap - Webbing.....\$49 (K0038)

HANGER EXTENSION OPTIONS

- PRO-30285 4" Telescoping Extensionsn/c
- PRO-30286 6" Telescoping Extensionsn/c
- PRO-30287 8" Telescoping Extensions.....n/c
Not available with all 90° hangers.
- PRO-30288 10" Telescoping Extensionsn/c
Not available with all 90° hangers.

- PRO-36402 4.5" Heavy Duty Extensions.....\$63
- PRO-36403 6.5" Heavy Duty Extensions.....\$74
Heavy duty extensions do not telescope adjust. Footrests adjust vertically in length on heavy duty extension tubes.
- PRO-36410 High Mount Clamp & Tubes\$110
- Clear Selection

Specialized Footrests

ALL legrest measurements are from the seat rail to footplate. Not available with LEAF or SRO seat rail options. Frame and/or front caster choice may limit adjustment range and/or cause interference.

SPECIALIZED FOOTREST SEAT RAIL TO FOOTPLATE MEASUREMENTS

Part Number	Extension	Super Contracture	3D Dynamic Hi Pivot	3D Dynamic STD
6402-01	Short	10.5" - 13.5"		
6402-02	Long	13.5" - 18.5"		
6405-01	0"-2" Extension		6.25" - 10.75"	12.75-15.25"
6409-01	1"-3" Extension		7.25-11.75"	13.75-16.25"
6406-01	2"-4" Extension		8.25-12.75"	14.75-17.25"
6410-01	3"-5" Extension		9.25-13.75"	15.75-18.25"
6407-01	4"-6" Extension		10.25-14.75"	16.75-19.25"
6411-01	5"-7" Extension		11.25-15.75"	17.75-20.25"
6508-01	6"-8" Extension		12.25-16.75"	18.75-21.25"



Length measured from top of footrest plate to top of seat rail. 3D HiPivot includes 4.5" of length adjustment, 3D includes 2.5" of length adjustment.

CONTRACTURE FOOTREST HANGERS

Super Contracture for frames 14" wide and greater only.

PRO-30291-2 Contracture Short - 11" to 15"\$3,838
Includes short hanger extension.

PRO-30292-2 Contracture Long - 15" to 19"\$3,838
Includes long hanger extension.

3D DYNAMIC FOOTREST HANGERS

PRO-30297-2 3D Dynamic Footrest - Hi Pivot.....\$7,300

PRO-30298-2 3D Dynamic Footrest - STD\$6,800

DYNAMIC FOOTREST EXTENSION OPTIONS

PRO-6405-01 Dynamic Adj Plantar/Dorsi Ext, 0-2".....n/c

PRO-6409-01 Dynamic Adj Plantar/Dorsi Ext, 1-3"n/c

PRO-6406-01 Dynamic Adj Plantar/Dorsi Ext, 2-4".....n/c

PRO-6410-01 Dynamic Adj Plantar/Dorsi Ext, 3-5"n/c

PRO-6407-01 Dynamic Adj Plantar/Dorsi Ext, 4-6".....n/c

PRO-6411-01 Dynamic Adj Plantar/Dorsi Ext, 5-7"n/c

PRO-6408-01 Dynamic Adj Plantar/Dorsi Ext, 6-8" ...n/c

SPECIALIZED FOOTPLATES

PRO-6503 4" x 6" HD Aluminum Footplates.....n/c

PRO-6504 5" x 8" HD Aluminum Footplates.....n/c
For frames 16" wide and greater only.

PRO-6505 6" x 10" HD Aluminum Footplates.....n/c
For frames 18" wide and greater only. Not available with Contracture Hangers

Armrests

BACK POST MOUNTED ARMRESTS

Omit Armrests

Foam wrap pad STD on all back post mounted armrests.

PRO-38204 10.5" Flip-Backn/c

PRO-38202 13.5" Flip-Backn/c

PRO-38210 10.5" to 13.5" Flip-Back
Locking, Telescoping\$307 (E0973)

Full length pad on 13.5" or longer armrests only.

PRO-38201 10.5" Flip-Back Locking.....\$285 (E0973)

PRO-38200 13.5" Flip-Back Locking\$285 (E0973)

PRO-38215 17" to 20" Flip-Back
Locking, Telescoping\$307 (E0973)

Armrest Heights

Armrest and Pad	Foam	Desk	Full
Flip Back	6.5" - 11.5"	7.5" - 12.5"	7.5" - 12.5"
Flip Back Locking	6.5" - 11.5"	7.5" - 12.5"	7.5" - 12.5"
Telescoping Flip Back	6.5" - 11.5"	7.5" - 12.5"	7.5" - 12.5"
Flip Back Locking Telescoping	6.5" - 11.5"	7.5" - 12.5"	7.5" - 12.5"
Single Post Height Adj. Short		8" - 14"	8" - 14"
Single Post Height Adj. Tall		10" - 16"	10" - 16"
Dual Post Fixed Height		9.5"	9.5"
Dual Post Flip Back Height Adj.		9" - 13"	9" - 13"

All heights from top of seat frame to top of armrest pad.



FRAME MOUNTED ARMRESTS

PRO-38217 Single Post Height Adjustable,
Removable - Low\$307 (E0973)

PRO-38203 Single Post Height Adjustable,
Removable - Standard.....\$307 (E0973)

PRO-38206 Dual Post Flip-Back Height
Adjustable, Removable\$318 (E0973)

PRO-38205 Dual Post Fixed Height Removablen/c
Not available with short frame. 22" & 24" Wheels not available with dual post armrests

ARM PAD OPTIONS

PRO-38213 Desk Length Padsn/c

PRO-38214 Full Length Padsn/c
13.5" or longer armrests only.

Casters

PRO-40000 4" x 1" Polyurethanen/c

PRO-43000 4" x 1.4" Poly, Aluminum Mag.....\$180

PRO-34555 5" x 1" Polyurethane.....n/c

PRO-34222 5" x 1.5" Polyurethane\$94

PRO-35050 5" Polyurethane Light-Up\$110

PRO-42000 5" x 1.4" Poly, Aluminum Mag\$180

PRO-34666 6" x 1" Polyurethane.....n/c

PRO-34999 6" x 1.5" Polyurethane\$94

PRO-44000 6" x 1.4" Poly, Aluminum Mag\$180

PRO-34444 6" x 2" Polyurethane, Treaded.....\$105

PRO-34777 7" x 1" Polyurethanen/c

PRO-34200 7" x 2" Foam Filled\$215



Yes, you can.®



PRO-CG™ Adult Manual Wheelchair

Wheel Options	12"	16"	18"	20"	22"	24"
MAGS for Polyurethane Tires - Full Profile	X	X	X	X	X	X
MAGS for Polyurethane Tires - Low Profile	X					
MAGS for Pneumatic Tires - <i>Compatible with all pneumatic tire options</i>	X	X	X	X	X	X
Spoke Wheel - Black <i>Compatible with all 16" & 18" tire options</i>		X	X			
Handrim Option				X	X	X
Tire Options						
Polyurethane Tires – Black, Full Profile	X	X	X	X	X	X
Polyurethane Tires - Black, Low Profile	X					
Pneumatic Tires – Black	X	X	X	X	X	X
Pneumatic Tires - Gray	X	X	X	X	X	X
Airless Inserts - <i>Compatible with all pneumatic tire options</i>	X	X	X	X	X	X

Rear Wheels

MAGS FOR PNEUMATIC TIRES

- PRO-31525 12" Mag Wheel.....n/c
12" mag wheels not available with 7" casters.
- PRO-31530 16" Mag Wheel..... \$45
- PRO-31533 18" Mag Wheel\$45
- PRO-31527 20" Mag Wheel - Aluminum Handrimn/c
- PRO-31528 22" Mag Wheel - Aluminum Handrim.....n/c
- PRO-31529 24" Mag Wheel - Aluminum Handrim.....n/c

SPOKE

- PRO-31535 16" Spoke Wheel - Black w/ Black Tire.....n/c
- PRO-31538 18" Spoke Wheel - Black w/ Black Tire.....n/c

HANDRIM OPTIONS

- PRO-31005 Plastic Coated Handrims.....\$130
20", 22" & 24" Mag wheels only, not available with drum brakes
- PRO-31006 Omit Handrims

PNEUMATIC TIRE OPTIONS

- PRO-31543 Black Pneumatic Tire.....n/c
- PRO-31544 Black Pneumatic Tire with Airless Inserts.....\$92 (E2213)
- PRO-31040 Gray Pneumatic Tire.....n/c (E2211, E2212)
- PRO-31000 Gray Pneumatic Tire with Airless Inserts.....\$92 (E2213)

MAGS FOR POLYURETHANE TIRES - FULL PROFILE

- PRO-31520 12" Wheel for Full Profile Poly.....n/c
- PRO-31522 16" Wheel for Full Profile Poly.....n/c
- PRO-31521 18" Wheel for Full Profile Poly.....n/c
- PRO-31519 20" Wheel for Full Profile Poly.....n/c
- PRO-31518 22" Wheel for Full Profile Poly.....n/c
- PRO-31517 24" Wheel for Full Profile Poly.....n/c

MAGS FOR POLYURETHANE TIRES - LOW PROFILE

- PRO-31526 12" Wheel for Low Profile Poly.....n/c

POLYURETHANE TIRE OPTIONS

- PRO-31516 Full Poly Black - 12", 20", 22", 24"n/c
- PRO-31515 Full Poly Black - 16, 18"\$80
- PRO-31045 Low Profile Polyurethane Tire.....n/c (E2218)
12" Mag wheel only, not available with drum brakes



Yes, you can.®



PRO-CG™ Adult Manual Wheelchair

Wheel/Caster Seat Rail to Floor Heights

Rear Wheel	Caster Wheel					
	4"	5"	6"	6 x 2"	7"	7 x 2"
12"	15"	15"	18.5"	18.5"	18.5"	18.5"
	15.5"	15.5"	19"	19"	19"	19"
	16"	16"				
	18.5"	18.5"				
	19"	19"				
16"	15"	15"	16"	16"	17"	17"
	15.5"	15.5"	16.5"	16.5"	17.5"	17.5"
	16"	16"	17"	17"	20"	20"
	16.5"	16.5"	17.5"	17.5"	20.5"	20.5"
	17"	17"	20"	20"		
18"	15"	15.5"	16"	16"	17"	17"
	15.5"	16"	16.5"	16.5"	17.5"	17.5"
	16"	16.5"	17"	17"	18"	18"
	16.5"	17"	17.5"	17.5"	18.5"	18.5"
	17"	17.5"	18"	18"		
20"	17.5"	18"	18.5"	18.5"		
	17"	17"	17"	17"	17"	17"
	17.5"	17.5"	17.5"	17.5"	17.5"	17.5"
	18"	18"	18"	18"	18"	18"
	18.5"	18.5"	18.5"	18.5"	18.5"	18.5"
22"	19"	19"	19"	19"	19"	19"
	19.5"	19.5"	19.5"	19.5"	20"	20"
	20"	20"	20"	20"		
	18"	18"	18"	18"	18"	18"
	18.5"	18.5"	18.5"	18.5"	18.5"	18.5"
24"	19"	19"	19"	19"	19"	19"
	19.5"	19.5"	19.5"	19.5"	20"	20"
	20"	20"	20"	20"	20.5"	20.5"
	18.5"	18.5"	19"	19"	19"	19"
	19"	19"	19.5"	19.5"	20"	20"
Clear Selection						

Use chart to determine seat rail to floor height. Caster sizes may vary slightly in height by type. Seat rail to floor heights are approximate, and are impacted by wheel type, caster size and braking choice. Heights can vary +/- 1/4". Seat pan choice increases seat rail to floor height 3/8" to 3/4".



Wheel Locks

STANDARD

PRO-31501 Push to Lock.....n/c

PRO-31506 Pull to Lock.....n/c

WHEEL LOCK OPTIONS

PRO-31801 Extension Handles \$81 (E0961)

DRUM LOCK

Includes manual wheel locks to be used with public transportation. Not available with 12" mag wheels with low pro poly tires. Not Available with 20", 22" & 24" Spoke Wheels.

PRO-31508 Foot Activated Wheel Lock.....n/c
Not available with ALL vent and battery trays.

PRO-30275 Hand Activated Brake
and Wheel Lock System \$1,000 (E2228)

Anti-Tippers

PRO-31600 Curb Assist Anti-Tip
Assembly Flip-Up, Adjustable.....\$135 (E0971)
Pair includes one anti-tip tube with curb assist feature.

PRO-31605 Spring Loaded Swing-Away
Anti-Tip Assy - Foot Activated \$194 (E0971)

Seat Pans

ALL seat pans include 2" x 2" notches for growth adjustment.

NON-ADJUSTABLE

PRO-39010 Fixed Solid Seat Pan - Composite..\$183 (E2231)
ALL Bolteron seat pans are made to fit frame dimensions unless specified below.

Seat Width _____" X Seat Depth _____"

PRO-39030 Fixed Solid Seat Pan - Aluminum.... \$215 (E2231)
Fixed Seat Pan raises the effective seat to floor height by 1/2".

Available in the following sizes ONLY:

14" wide x 16" deep

16" wide x 18" deep

18" wide x 18" deep

ADJUSTABLE

PRO-39040 Fixed, Width Adjustable
Solid Seat Pan - Aluminum..... \$312 (E2231)
Fixed Seat Pan raises the effective seat to floor height by 1/2".
Width Adjustable Solid Seat Pan adjusts 2" in width (in 1" increments)
by assembly hardware to grow with PRO frame.

Available in the following sizes ONLY:

14"-16" wide x 16" deep

16"-18" wide x 18" deep

MOUNTING HARDWARE OPTIONS

Use to convert fixed seat pan to removable.

PRO-EZLITE Removable Pan Hardware Kit..... \$223 (K0108)
Removable Seat Pan Hardware raises the effective seat to floor height by 5/8".
Includes 4-points of EZ-Lite mounting hardware, 2 each frame stopper clamps.

PRO-DROP1 1" Drop Pan Hardware Kit \$223 (K0108)

PRO-DROP2 2" Drop Pan Hardware Kit..... \$223 (K0108)
Includes 4 each 2" drop hooks, 4 each 408 clamps, & 2 each Glide Lock
clamps. Not available with ANY Aluminum Solid Seat Pan.



Yes, you can.®



PRO-CG™ Adult Manual Wheelchair

Accessories

PRO-10920 Tilt Range Limit Kit.....\$38 (K0108)

Pins install into outside of tilt channel to limit tilt travel.

SFDI-9HP Footrest Hanger Pads - Pair\$112 (K0108)

Wrap-around pads made from black neoprene.

PRO-23210 Flip-Down Rigidizing Bar.....\$189 (K0108)

Mounts to back post tubes to add rigidity to frame. Does NOT adjust in width to grow with frame.

PRO-10900 Freedom Backpack.....\$65 (K0108)

Black Nylon only with Freedom Designs logo. Monogramming is not available on Freedom Backpack.

PRO-10905 Freedom Canopy - Flip-Back.....n/c (K0108)

Canopy assembly includes removable mounting hardware. Available in black only with Freedom Designs logo. Includes rear flap with zippered storage pocket and clear-view window.

Specifications

Frame Style	Tilt-In-Space
Base Frame Widths	16", 18", 20"
Overall Width	Base width + 7.5" (all wheels without drum lock) Base width + 8.5" (with drum lock except 16" & 18" mag wheel) Base width + 9.5" (with drum brake and 16" or 18" mag wheel)
Seat Widths	14" - 20"
Seat Depths	14" - 26"
Back Heights	20", 23", 26"
Adjustable Angle Back	90°, 100°, 110°, 120°
Tilt Range	0° to 55°
Recline Back	162°
Weight Limit	250 LBS.
Transport Weight	
Warranty	Lifetime on frame

Special Configurations Through Customer Service

Anterior Tilt	As much as -5° depending on configuration. Reduces posterior tilt angle by same amount.
Asymmetrical Seat Depth	Seat rails may be configured up to 4" offset

HCPCS Codes

are provided based on verification through PDAC or our interpretation of the code definitions. The use of HCPCS codes does not ensure coverage or payment. For coverage information, verify the appropriate payer's coverage policy.

Save

Adobe Acrobat Reader DC allows you to save this form with your content - to complete later or use as a starting point for your next form.

Please note that content must be added and saved in Acrobat - saving content from completed forms in the browser may not be possible.

Submit

Adobe Acrobat Reader DC allows you to submit this form electronically via your email client.

Simply click the submit button below and step through the simple process.

Print

If you do not have access to Adobe Acrobat Reader DC simply print this form and complete it by hand and fax it to our Customer Service Department at:

800-331-8551